

Driving directions from the A259.

Your sat nav or Google maps will take you as far as Old Lydd Road and Camber Central Car Park but the final directions will not take you to the Beach House itself.

From the A259 you will turn into Camber Road (signposted Camber, Lydd Airport),

Continue into New Lydd Road, past Rye Golf Course and into Camber village.

Turn right into Old Lydd Road (there is a signpost 'beach') and The Gallivant Bistro on your left.

Follow the road until you reach a car park at the end.

Drive to the far right hand side of the car park towards the beach, and Marine Cottages are directly on the beach, in front of the sand dunes.

Please make sure you park in the allocated bays using the parking permit provided inside the cottage.

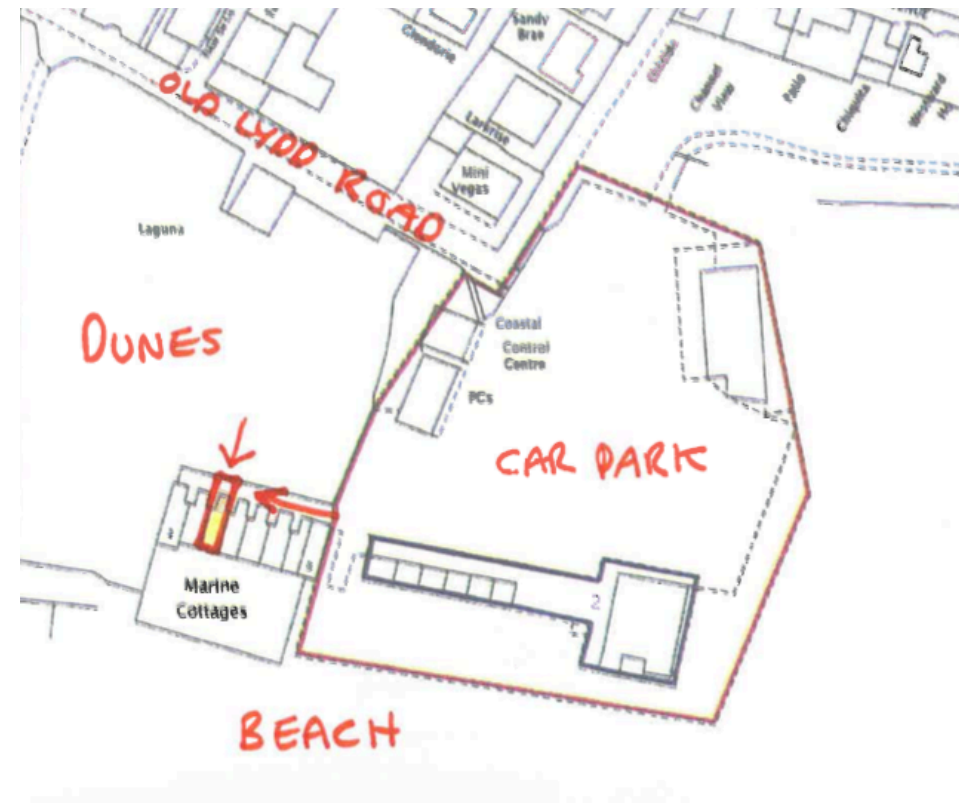

Map from Camber Road to Central Car Park

